

OPAL

PERFORMANCE ROOFLIGHT

INSTALLATION GUIDE

MARCH 2019
VERSION 1.0

CONTENTS.

Introduction	2
Tools required	2
Fixing kit includes	2
Product overview	3
Technical details	3
Technical overview	4
Roof-light installation	5
Roof-light installation	6

INTRODUCTION.

This universal guide provides a general overview of the installation of the Prefix Opal Rooflight. Any areas or details not covered in this guide can be discussed with our technical support team on 01254 871800.

This guide is written on the basis that an accurate site survey has been undertaken and correct checks have been carried out to ensure structural performance of any new or existing walls, frames and foundations are fit for purpose and the aperture has been cut in line with the Opal Roof-light guide lines prior assembly.

Please take a moment to read through this guide and the 'Technical Section'. All feedback is welcome.

Please take care when handling glass and painted product as surfaces may become scratched. Prior installation please open all packs and inspect for damaged or missing goods, and report any issues to our Customer Care department.

Important Note: Please ensure correct PPE and glass handling equipment is used.

TOOLS REQUIRED.



Battery / Drill Driver

Sealant Gun

PZ2 Pozidriv Bit

Utility Knife

Spirit Level

Tape Measure

FITTING KIT INCLUDES.

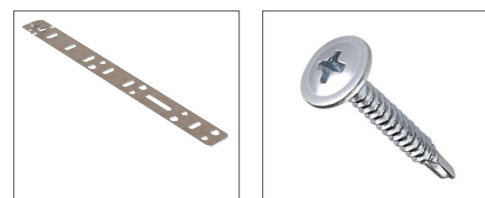

240mm fixing Strap (C0009)

4.0 x 16mm self-drilling wafer head screw

PRODUCT OVERVIEW.

Product Specification

- Thermally broken aluminium profile framework
- Powder coated in 7016 Anthracite Grey (as standard)
- Bespoke colours available
- Double Glazed 1.2 U-Value , 6mm Toughened Safety Glass, Argon Filled, 95mm Ceramic Border
- Fully Glazed
- No exterior trims, flashings or fixings

Sizes and Availability

- Stock Sizes: (Internal Kerb - excluding plasterboard - based on 75mm kerb)
- 1000 x 1000
- 1000 x 1500
- 1000 x 2000
- Bespoke Sizes available up to:
- 1500mm Max. Width (External)
- 3000mm Max. Length (External)
- Maximum Glazed Area of 3m²

Installation

- Minimum pitch of 5° required on kerb to prevent standing water on glazing
- Internal fixing straps provide a secure hidden fixture
- Flashing from roof deck to be supplied by installer.

TECHNICAL DETAILS.

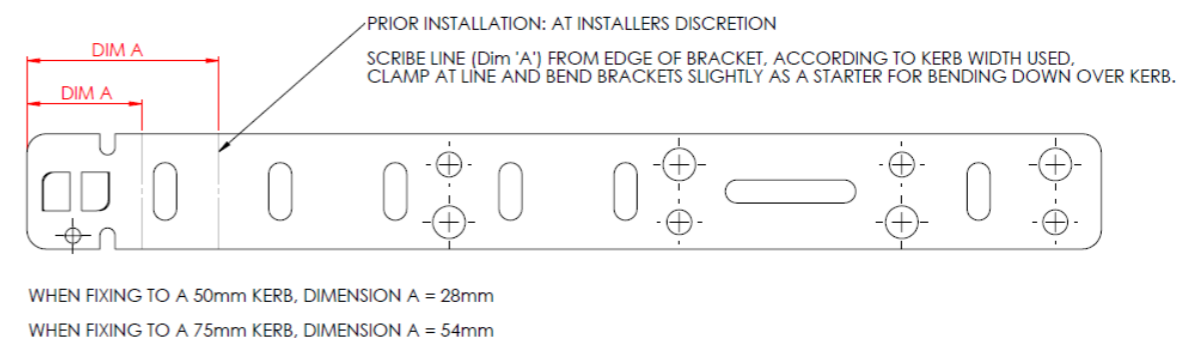

IMPORTANT: Kerb size to be specified at point of order to ensure rooflight fits over kerb

TECHNICAL OVERVIEW.

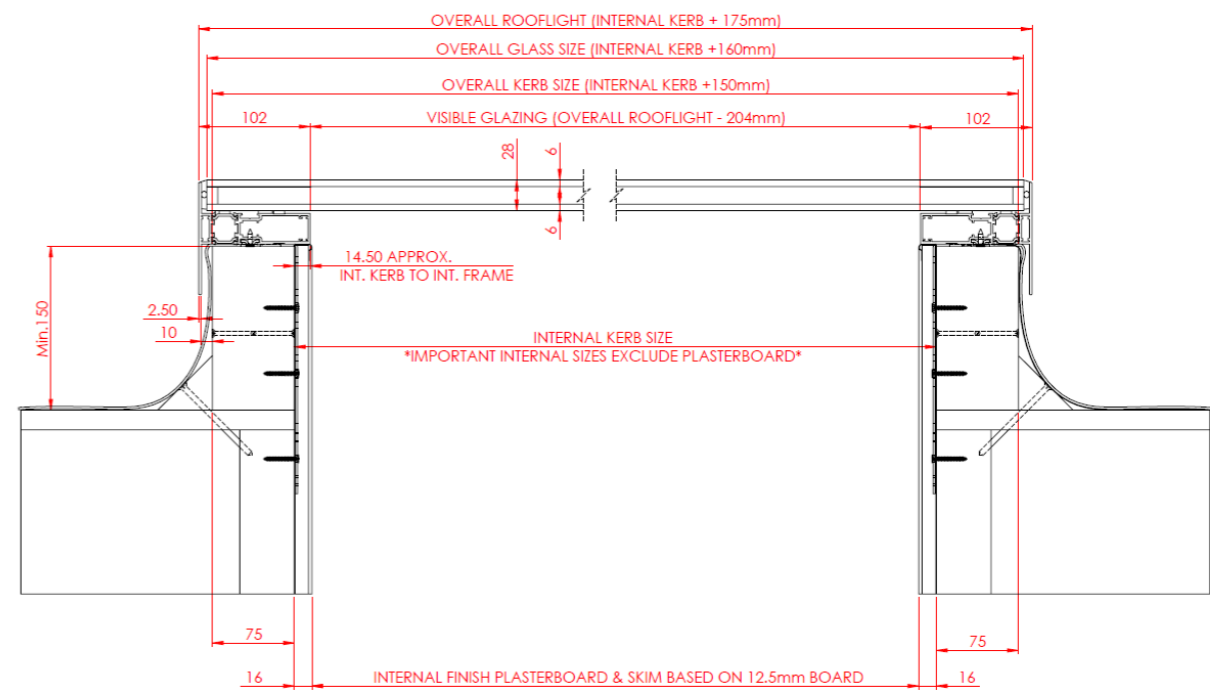
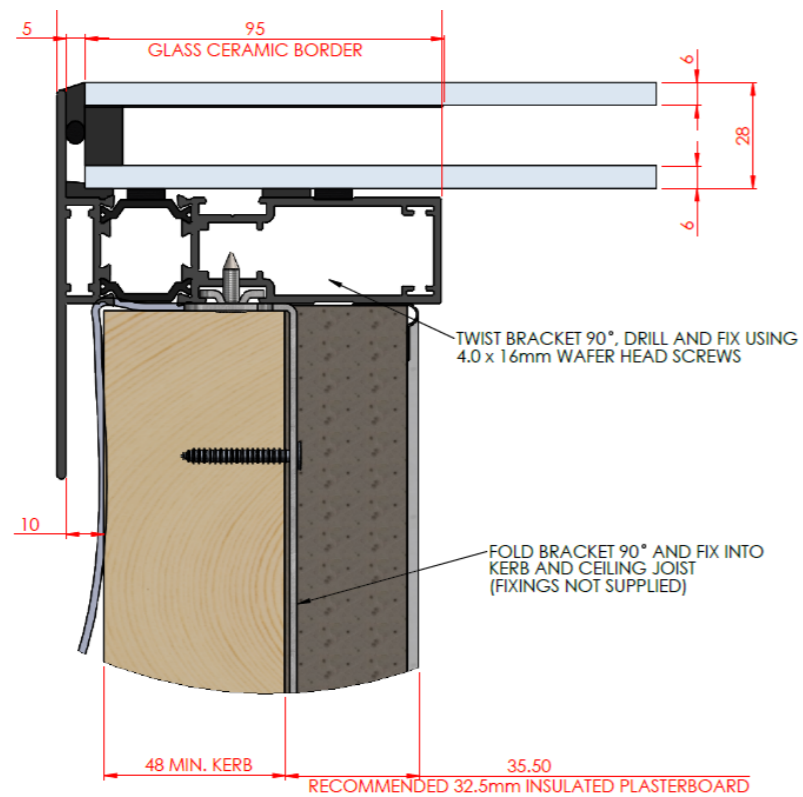
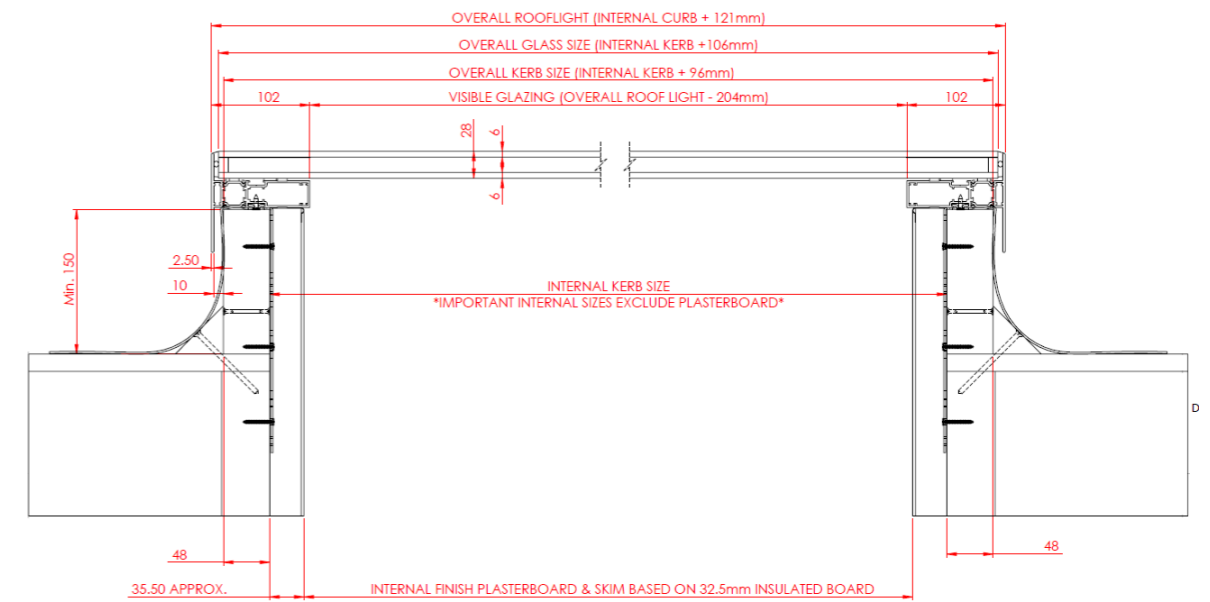
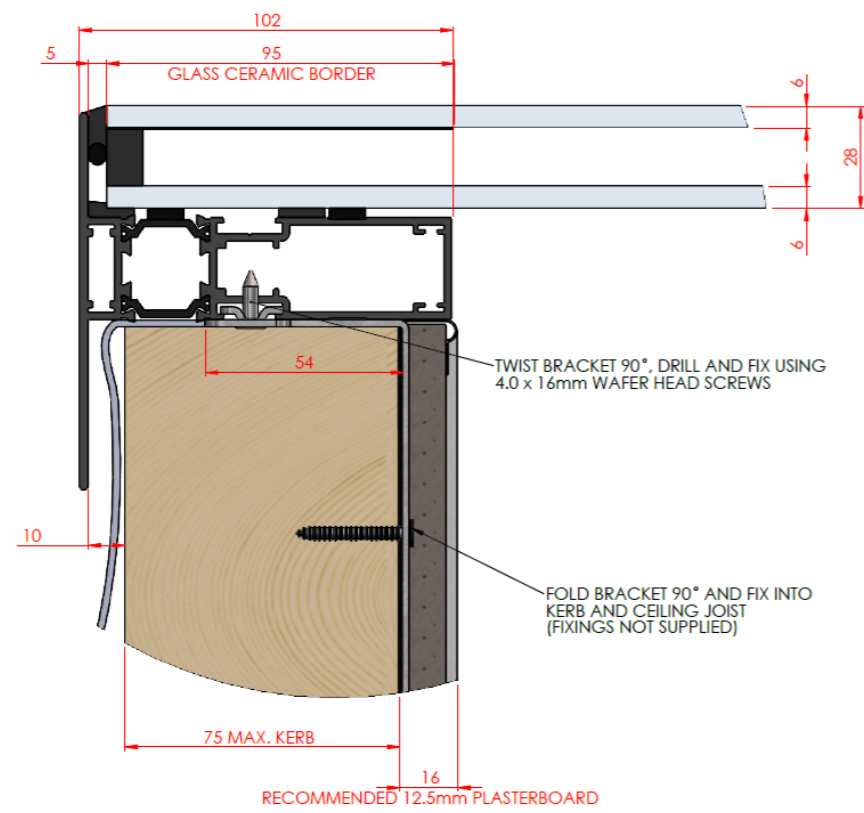

IMPORTANT: Kerb size to be specified at point of order to ensure rooflight fits over kerb

ROOF-LIGHT INSTALLATION.

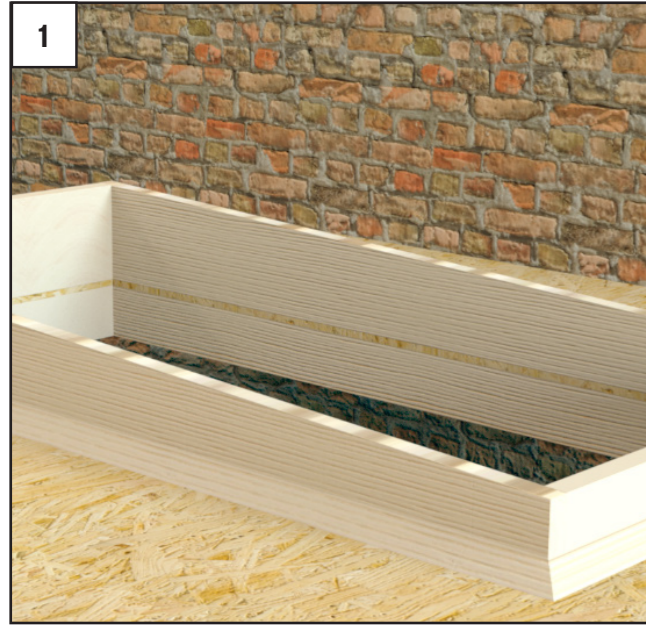

Align and fix down kerb with aperture. Measure diagonal corners to check size and square. Apply tilt fillets (not included in kit) to give fall of 5° - See tech detail on page 3 prior to step 2.

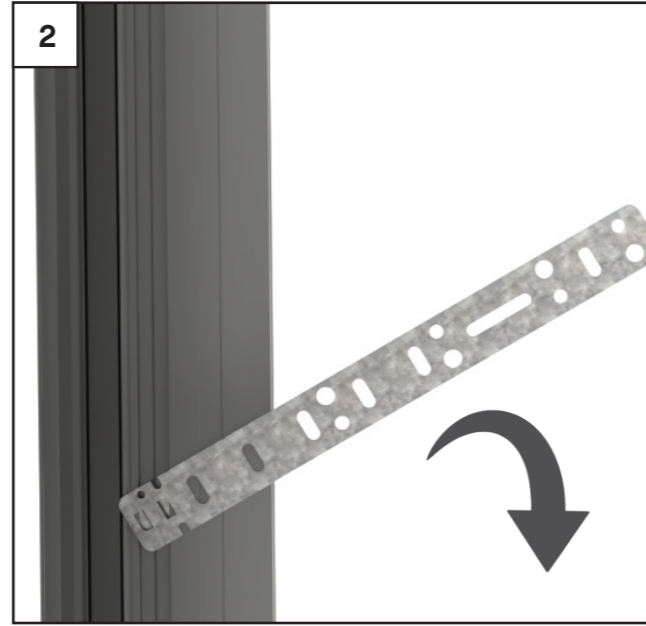

Prior Installation, carefully remove roof light from packaging, place upside down ensuring glass face is protected.

Quarter turn fixing straps clockwise into roof light channel until perpendicular to internal edge of roof light. Brackets required 100mm in from each corner and approx. 500mm centres.

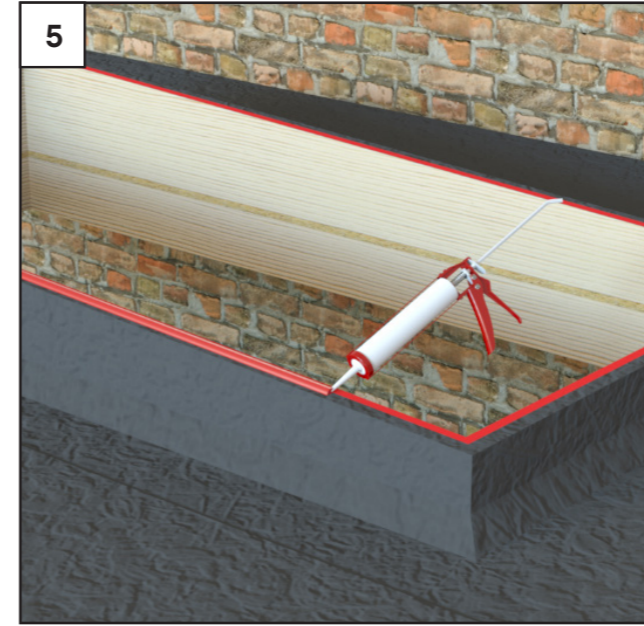

Apply generous bead of sealant continuously around perimeter on the top edge of the kerb.

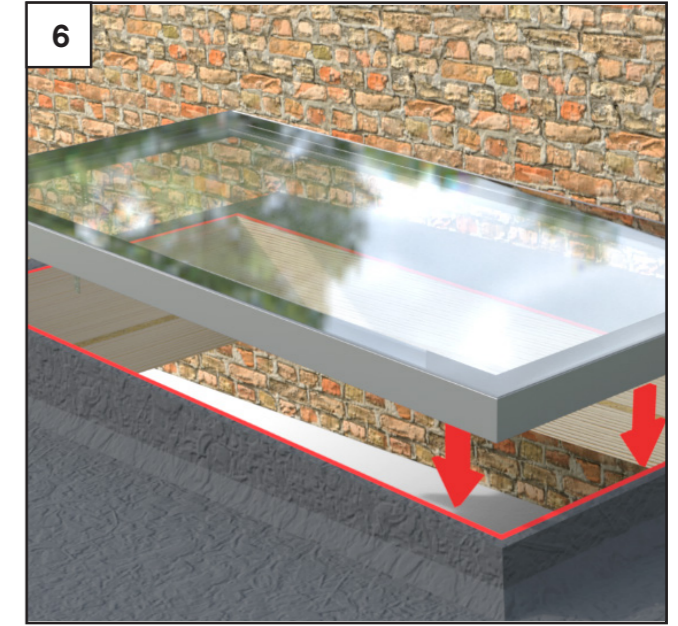

Fit the roof light over the kerb, ensure square and apply pressure to seal against the kerb edge. Larger units may require multiple people to lift

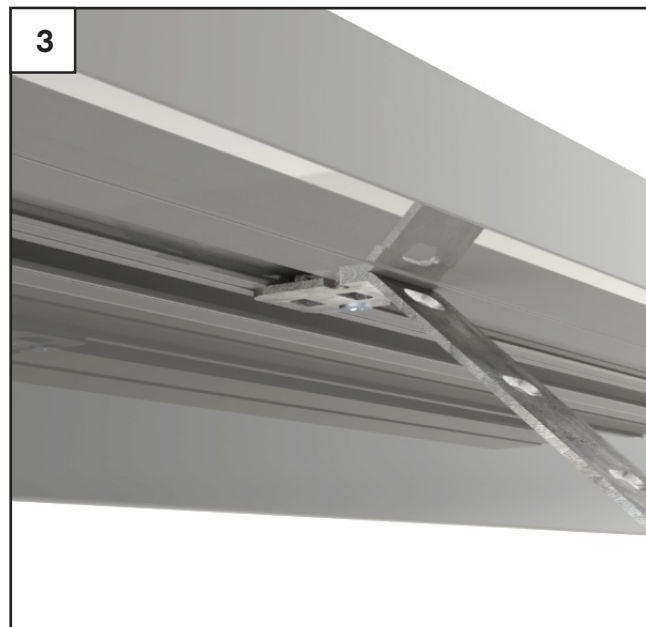

Using a 4 x 16 wafer head screw, fasten bracket in up into the profile as close to the bend as possible using the pre formed holes in the brackets until all brackets are secured.

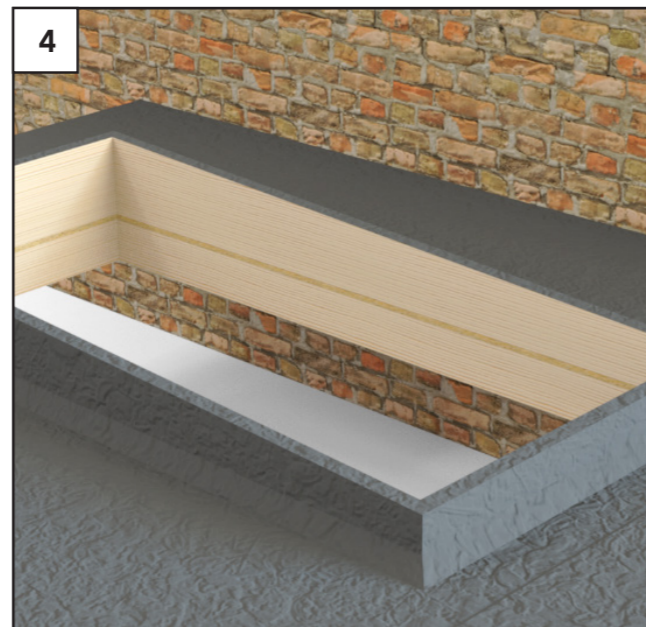

Roof coverings can be applied before or after the roof light is installed. Wrap membrane on to top of kerb make certain of watertight finish When applying after, fold back membrane on itself and tuck up under the lip of the roof light frame, and seal, ensuring water tight.

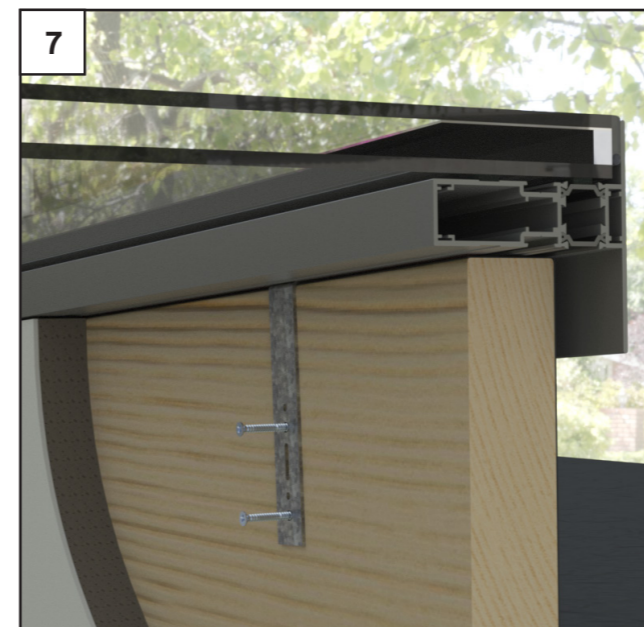

Bend brackets flush against kerb upstand and fix using suitable fixings for substrate.

Fit plasterboard flush to underside of profile and skim up to profile edge.

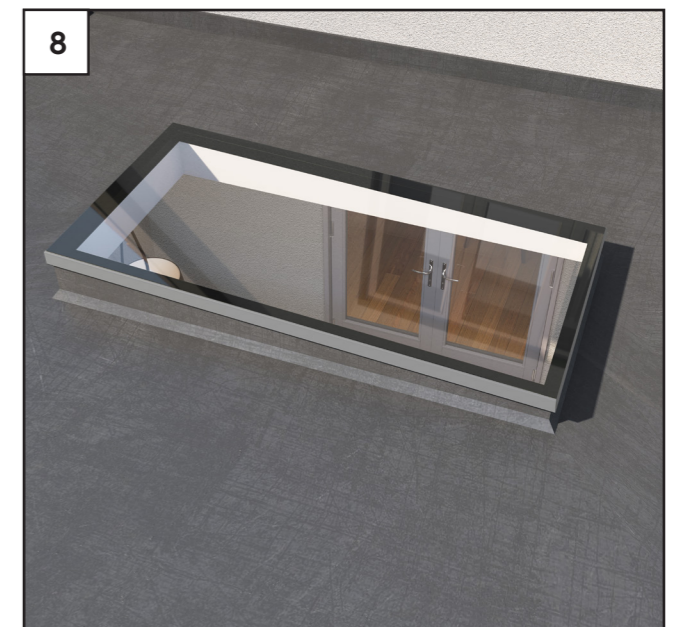

Installed rooflight.

OPAL

PERFORMANCE ROOFLIGHT

PREFIX (UK) Ltd

Systems House | Cunliffe Road | Blackburn
Lancashire | BB1 5UA
T: 01254 871800

PREFIX (SOUTH) Ltd

Unit 16 Barn Way | Lodge Farm Ind. Estate
East Dunston | Northampton | NN5 7UW
T: 01604 750212

PREFIX (SOUTH WEST) Ltd

Unit 7 Ystrad Trade Park | Ystrad Road
Fforestfach | Swansea | SA5 4JB
T: 01792 588254

PAVILION SYSTEMS Ltd

Unit B2 Ford Airfield Ind. Estate
Ford | Arundel | West Sussex | BN18 0HY
T: 01903 739440

W: www.prefixsystems.co.uk

E: warmroof@prefixsystems.co.uk

 @prefixsystems

 Prefix Systems

 @prefixsystems



MARCH 2019
VERSION 1.0